

so you think all window companies are the same... **think again!**

sternfenster

windowsystems

uPVC Door Installation Guide

A clear, practical guide that allows you to install our high quality uPVC doors with ease.

- Before starting, carefully check the new frame measurements are correct against the survey size and the actual aperture sizes. The new frame should be at least 10mm smaller than the opening to allow for expansion. Also, check the new frame and glass to ensure that there are no obvious quality issues



- Using a sharp blade, break both the internal and external seals between the old frame and the building. If possible carefully take off the old door leaf before removing any visible fixings and removing the outer frame, taking care not to damage the surrounding.

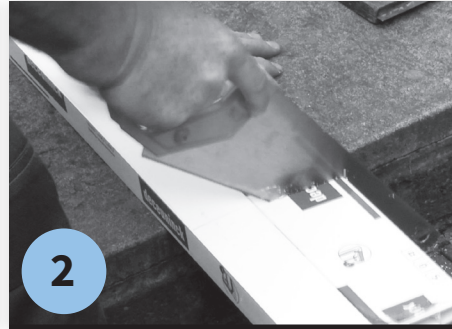

- Once removed, clear away any debris and old sealant from the opening.
- Prepare the external cill by cutting it to size, this can be a straight cut or rebated if being fitted with projecting horns.



- Secure the cill end caps in place with a strong adhesive, e.g. super glue.

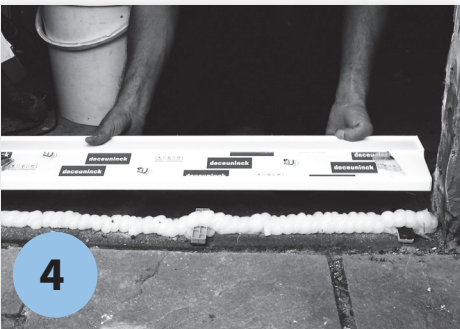

- Offer the cill into position, check that it is level and use plastic packers as required. Once level carefully lift the cill out without disturbing the packets, apply a generous amount of silicone onto the brickwork before repositioning the cill.



- Carefully silicone along the cill up-stand and at both ends, this is to prevent water and air leaks occurring between the cill, frame and surrounding.



- Fit the handle before fitting the door into the aperture.



- Offer up the new frame and position it on the cill, ensure the frame is level and plumb whilst making sure that you maintain an equal expansion gap around the frame.
- The frame is ready to be secured in place, fixings should be located approximately 150mm in from each corner and then spaced at 600mm intervals. Do not fix within 150mm of any mullions or transoms. Ideally you should use at least 5 fixings per jamb and 1 in the head of the frame.



- Using suitable uPVC fixings, secure through the frame into the building. Start at the bottom of the hinge side and work up before repeating on the opposite side.
- It is important to use plastic packers between the frame and the building at all fixing points to ensure that the frame is not distorted when tightening the screws.



- Before tightening the screws check that the frame is still level and plumb. Take care not to over tighten the screws and distort the frame.
- Check the operation of the door to ensure that it opens and closes without catching.

so you think all window companies are the same... **think again!**



10

- Once fixed, clean away any dust or dirt before removing the internal glazing beads. Ensure that you don't mix these up as they need to go back in the same positions on the frame.
- Place bridging packers in both sides of the bottom corner on the hinge side. Then both sides of the top corner on the handle side.



11

- Offer up the glass and rest it on the bridging packers, this will ensure that the glass is raised above the internal drainage channels. Insert plastic glass packers in between the edge of the glass and the bridging packers, this secures the glass in position and squares up the glass in the frames.

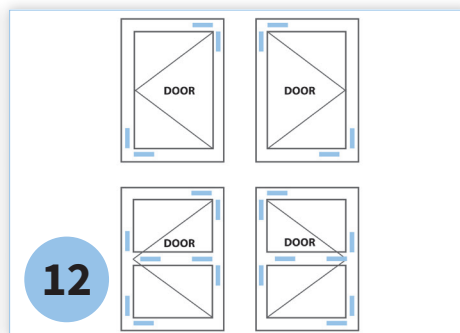

12

- Ensure that you follow these guidelines for 'toe and heeling' the glass, otherwise you could have operational issues when opening and closing any sashes. If you find the sash is catching at the bottom when used, you will need to insert more glass packers in the top corner of the handle side, this will push the sash up.



13

- Once you are happy with the position of the glass packers and you have tested to make sure the door opens and closes correctly and the glass is square in the frame you should apply silicone either side of the packers to help keep them in place.



14

- Now refit the beads in the same position as you removed them, start with the smallest lengths first before inserting the longer lengths. Use a rubber mallet/hammer to help tap the beads into position, focus on the edge where the bead meets the frame.



15

- Break off any excess packers with a chisel before cleaning the frame and glass down.



16

- If required, measure and cut uPVC trims before fixing them in place with a strong adhesive, e.g. super glue.



17

- Seal inside and out with a silicone seal. We recommend applying masking tape to the frame so that you get a neat finish. It is imperative to also seal along the underside of the external cill. Finally, fit any trickle vents.

Watch the full installation of this door, as well as many more products, at www.sternfenster.com/videos

sternfenster
window systems

No.5 The Works, Waterside South, Lincoln. LN5 7JD Tel. **01522 512525** Fax. **01522 567651**
www.sternfenster.com email: sales@sternfenster.co.uk



We reserve the right to make changes to the product specification as technical developments dictate and without prior notice. Pictures shown in this brochure are for illustrative purposes only and are not binding in specification or detail.

For technical reasons associated with colour reproduction, the colours shown give only an indication of shade; no guarantee can be given that they will exactly match the actual product finish.